

**NOTE:**

WALK TO BE DIVIDED INTO EQUALLY SPACED BLOCKS AT APPROXIMATELY 5' INTERVALS. EXPANSION JOINT FILLER 1/2" THICK SHALL BE INSTALLED BETWEEN WALK AND ANY FIXED STRUCTURE, EXTENDING FOR THE FULL DEPTH OF THE SIDEWALK. THE EXPANSION JOINT FILLER SHALL BE 1" THICK WHERE WALK IS INSTALLED AGAINST BACK OF CURB.

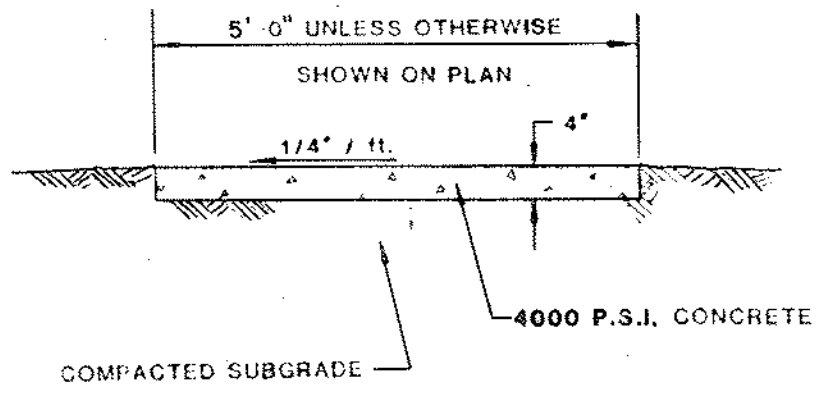

**TYPICAL SIDEWALK DETAIL**  
(N.T.S.)

WASHED GRAVEL OR EQUAL.  
(SLAG NOT PERMITTED)

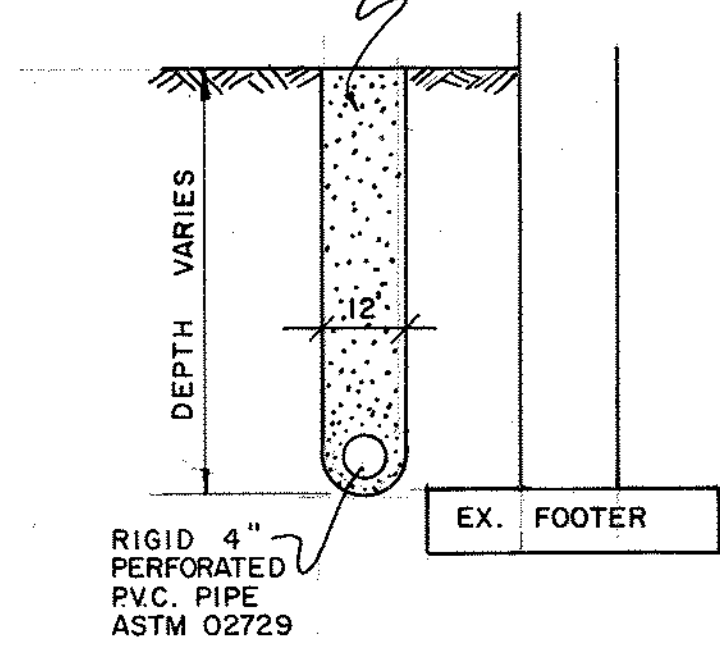

**FOOTER DRAIN DETAIL**  
(N.T.S.)

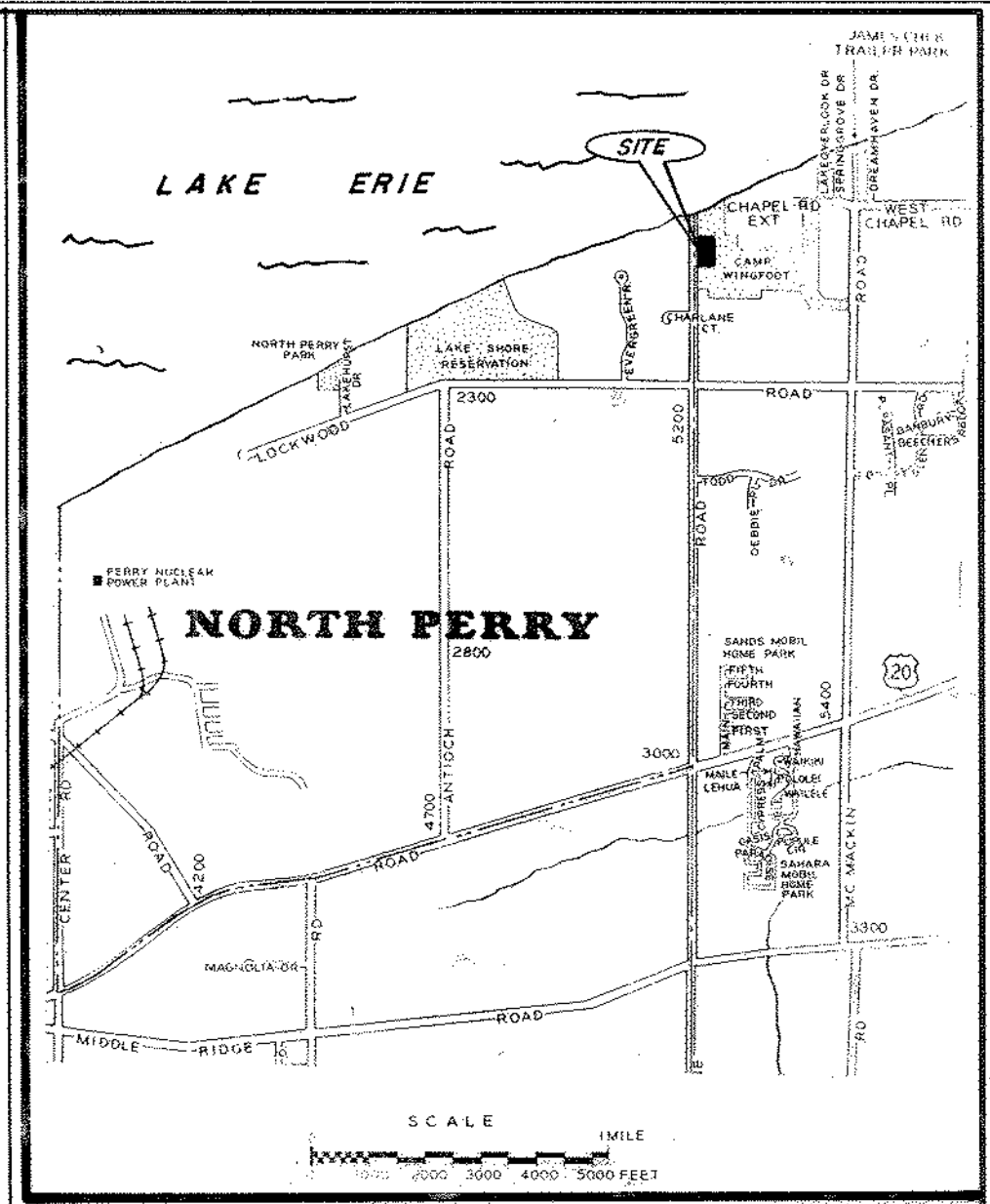

**VICINITY MAP**

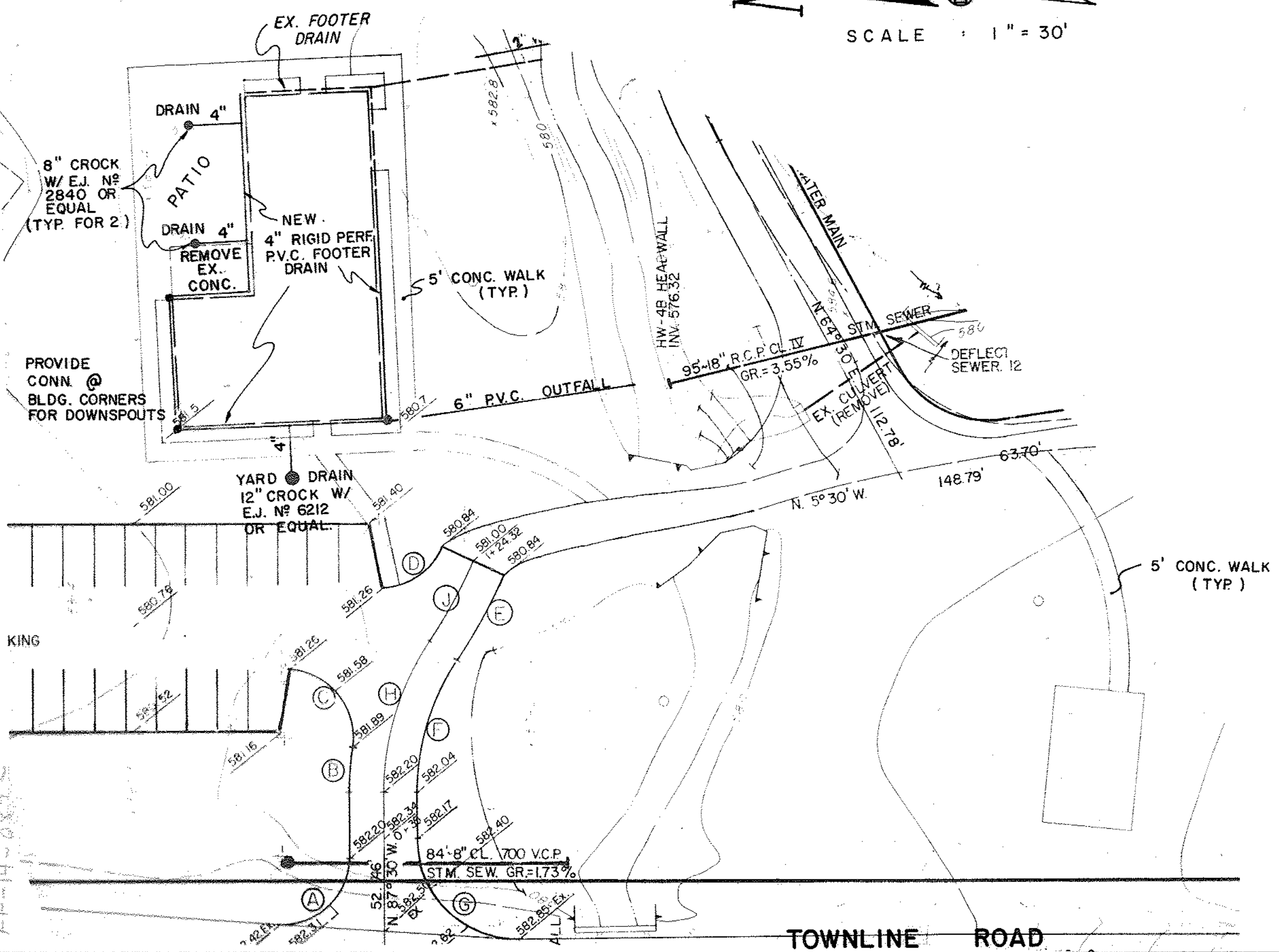

NPV 063